

High performance cutters *Hochleistungsfräser*

FMP12 EMP01
EMP13 EMP02

New

FMA07 FMA12
FMA11 FMD02



ZCC Cutting Tools Europe GmbH

your Partner | your Value

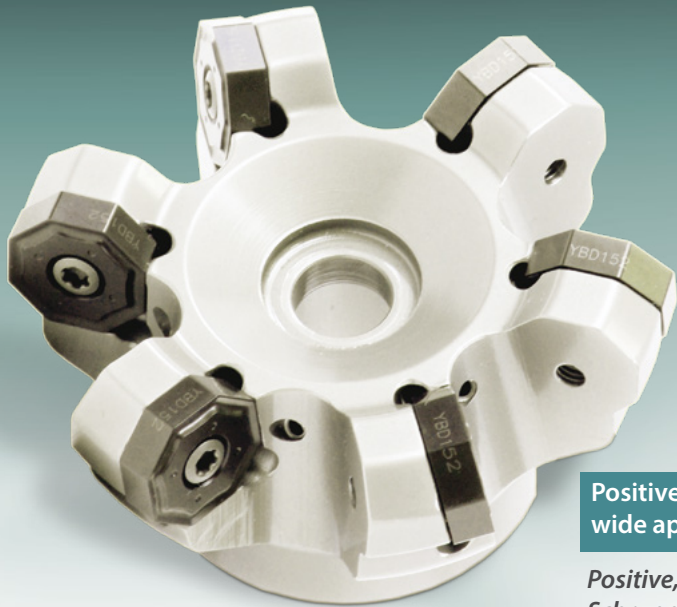

FMA07

Stable double sided insert with 16 cutting edges for high productivity.

Stabile doppelseitige Wendeschneidplatte mit 16 Schneidecken für hohe Wirtschaftlichkeit.

Positive light cutting chip breaker for finishing to roughing in a wide application field.

Positive, leicht schneidende Spanbrecherform für die Schlicht- bis Schruppbearbeitung mit weitem Anwendungsspektrum.

Cutter body diameter $\varnothing 25$ to $\varnothing 315$, inserts ONHU06** and ONHU08**, grades:

Fräserdurchmesser $\varnothing 25$ bis $\varnothing 315$, WSP ONHU06** und ONHU08**, in den Sorten:

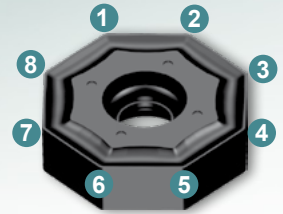

YBC302

CVD
P15 - P35

YBG202

PVD
P10 - P30

YBM253

CVD
P20 - P40

YBM351

CVD
P25 - P40

YBG205

PVD
P10 - P30
M20 - M30

YB9320

PVD
P15 - P25
M20 - M30

YBD152

CVD
K05 - K25

Face milling / Planfräser

Kr:45°



FMA07 P K

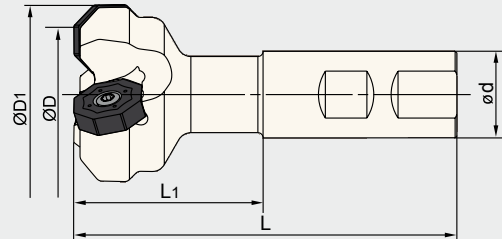

Type Typ	Stock Lager	Dimension Abmessung (mm)							Tooth Zähne Z	Weight Gewicht (kg)	
		R	L	ØD	ØD ₁	ød	L	L ₁			a _{pmax}
FMA07 -025-XP20-ON06-02	● ○			25	37	20	95	45	4	2	0.2
-025-XP20-ON06-02C	* ● ○			25	37	20	95	45	4	2	0.2
-032-XP25-ON06-02C	* ● ○			32	44	25	111	55	4	2	0.4
-040-XP25-ON06-03	● ○			40	52	25	106	50	4	3	0.4
-032-XP25-ON08-02	● ○			32	47	25	111	55	5	2	0.4
-032-XP25-ON08-02C	* ● ○			32	47	25	111	55	5	2	0.4
-040-XP25-ON08-03	● ○			40	55	25	111	55	5	3	0.5
-040-XP25-ON08-03C	* ○ ○			40	55	25	111	55	5	3	0.5
-050-XP25-ON08-04	● ○			50	65	25	111	55	5	4	0.6

■ Spare Parts · Ersatzteile

● Ex stock / ab Lager ○ On demand / auf Anfrage

* With internal cooling · Mit Innenkühlung

Diameter Durchmesser ØD	Insert WSP	Screw Schraube	Wrench Schlüssel	
Ø25 - Ø40	ONHU06** - PF/PM/W	I60M4×10	--	WT15IS
Ø32 - Ø50	ONHU08** - PF/PM/W	I60M5×13	WT20IT	--



Face milling / Planfräser

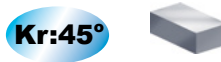

FMA07 P M K

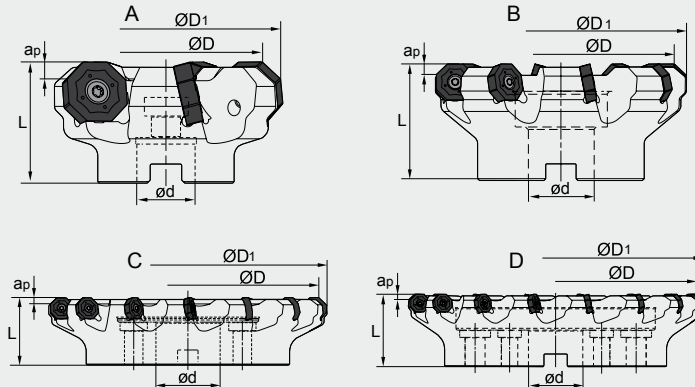

Type Typ	Stock Lager	Dimension Abmessung (mm)							Tooth Zähne Z	Coupling Aufnahme	Weight Gewicht (kg)
		R	L	ØD	ØD ₁	ød	L	a _{p,max}			
FMA07		●	○	50	62	22	40	4	5	A	0.3
-050-A22-ON06-05C	*	●	○	50	62	22	40	4	5	A	0.3
-063-A22-ON06-06		●	○	63	75	22	40	4	6	A	0.5
-063-A22-ON06-06C	*	●	○	63	75	22	40	4	6	A	0.5
-080-A27-ON06-07C	*	●	○	80	92	27	50	4	7	A	1.0
-080-B27-ON06-07		●	○	80	92	27	50	4	7	B	1.0
-080-B27-ON06-07C	*	●	○	80	92	27	50	4	7	B	1.0
-100-B32-ON06-08		●	○	100	112	32	63	4	8	B	1.9
-100-B32-ON06-08C	*	●	○	100	112	32	63	4	8	B	1.9
-125-B40-ON06-09		●	○	125	137	40	63	4	9	B	3.5
-125-B40-ON06-09C	*	●	○	125	137	40	63	4	9	B	3.5
-160-C40-ON06-11		●	○	160	172	40	63	4	11	C	4.3
-200-C60-ON06-13		○	○	200	212	60	63	4	13	C	6.4
-250-C60-ON06-15		○	○	250	262	60	63	4	15	C	13.4
-315-D60-ON06-17		○	○	315	327	60	80	4	17	D	21.9
-063-A22-ON08-05		●	○	63	78	22	40	5	5	A	0.5
-063-A22-ON08-05C	*	●	○	63	78	22	40	5	5	A	0.5
-080-A27-ON08-06C	*	○	○	80	95	27	50	5	6	A	0.9
-080-B27-ON08-06		●	○	80	95	27	50	5	6	B	0.9
-080-B27-ON08-06C	*	○	○	80	95	27	50	5	6	B	0.9
-100-B32-ON08-07		●	○	100	115	32	63	5	7	B	1.8
-100-B32-ON08-07C	*	●	○	100	115	32	63	5	8	B	3.1
-125-B40-ON08-08		●	○	125	140	40	63	5	8	B	3.1
-125-B40-ON08-08C	*	●	○	125	140	40	63	5	8	B	3.1
-160-C40-ON08-10		●	○	160	175	40	63	5	10	C	4.1
-200-C60-ON08-12		●	○	200	215	60	63	5	12	C	6.1
-250-C60-ON08-14		●	○	250	265	60	63	5	14	C	12.0
-315-D60-ON08-16		○	○	315	330	60	80	5	16	D	21.0

Spare Parts - Ersatzteile

Diameter Durchmesser ØD	Insert WSP	Screw Schraube	Wrench Schlüssel	
Ø50 - Ø315	ONHU06**-PF/PM/W	I60M4×10	--	WT15IS
Ø63 - Ø315	ONHU08**-PF/PM/W	I60M5×13	WT20IT	--

Coupling Aufnahme	Diameter Durchmesser Ø D	Screw-Schraube	Ring-Dichtring
B27	Ø80	LDB27C	B27-002-CP
B32	Ø100	LDB32C	B32-002-CP
B40	Ø125	LDB40C	B40-002-CP

● Ex Stock / ab Lager ○ On demand / auf Anfrage * With internal cooling - Mit Innenkühlung

Milling - Fräsen

Indexable Milling Tools - Wendepplattenfräser

Applicable inserts Wendeschneidplatten

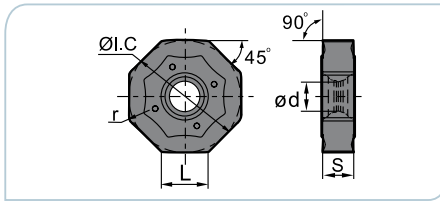

Workpiece Material Werkstoff	Ideal Machining Condition Gute Bearbeitungsbedingungen			Normal Machining Condition Normale Bearbeitungsbedingungen			Unfavorable Machining Condition Ungünstige Bearbeitungsbedingungen		
	P	M	K	P	M	K	P	M	K
P Steel Stahl	●	●	●	●	●	●	●	●	●
M Stainless Steel Rostfreier Stahl	●	●	●	●	●	●	●	●	●
K Cast iron Gusseisen	●	●	●	●	●	●	●	●	●
N Non-ferrous material Nichtmetalle	●	●	●	●	●	●	●	●	●
S Heat-resistant steel Wärmebeständiger Stahl	●	●	●	●	●	●	●	●	●

Insert WSP	Type Typ	Dimension Abmessung (mm)					CVD Coating CVD Beschicht.				PVD Coating PVD Beschicht.				Cermet Cermet	Carbide uncoat. unb. Hartmetall					
		L	ØI.C	S	ød	r	YBC302	YBC301	YBC401	YBM253	YBM251	YBM351	YBD152	YBD252			YBG102	YB9320	YBG205	YBG202	
	ONHU060408-PF	6.58	15.875	4.76	4.4	0.83	●			●		○				●					
	ONHU08T508-PF	8.39	20.2	5.79	5.3	0.83	●			●		●			●		●				
	ONHU060408-PM	6.58	15.875	4.76	4.4	0.83	●			●		●				○					
	ONHU08T508-PM	8.39	20.2	5.79	5.3	0.83	●			●		●									
	ONHU08T508-W	6.9	20.5	6.00	5.3	0.80								●	○						

Cutting Data / Schnittdaten

● Ex Stock / ab Lager ○ On demand / auf Anfrage

Workpiece material Werkstück Material	Hardness HB Härte	Grade Sorte	Cutting data · Schnittdaten				
			V _c (m/min)	f _z (mm/z)	a _p (mm)		
					ONHU06**-PM	ONHU08**-PM	
P Low-carbon steel Soft steel Niedriglegierter Kohlenstoffstahl Baustahl	≤180	YBC302	270 (220-350)	0.2 (0.1-0.4)	4	5	
		YBG202					
	180-280	YBC302	240 (200-320)	0.2 (0.1-0.4)	4	5	
		YBG202	240 (180-350)	0.2 (0.1-0.4)	4	5	
		YBM253	260 (200-320)	0.2 (0.1-0.4)	4	5	
280-350	YBM351	200 (180-280)	0.2 (0.1-0.4)	4	5		
	YBM253	240 (180-300)	0.2 (0.1-0.4)	4	5		
M Stainless steel Rostfreier Stahl	≤270	YBM253	230(180-300)	0.2(0.1-0.3)	4	5	
K Cast iron Gusseisen	180-250	YBD152	270 (150-300)	0.4 (0.1-0.5)	4	5	

For Example / Beispiele

Milling Tools / Fräser: FMA07-100-B32-ON08-07
 Insert / WSP: ONHU08T508-PM YBD152
 Parts / Teile: Case of gear pump / Pumpengehäuse
 Workpiece material / Werkstückstoff: HT400
 Cooling system / Kühlsystem: dry cutting / trocken
 Machine / Maschine: CNC floor Type / CNC Maschine
 Cutting data / Schnittdaten: V_c=267m/min f_z=0.42mm/z
 a_p=1.5mm a_e=80mm
 Direction / Richtung: Climb milling / Gleichlaufräsen
 Processing site / Bearbeitungsebene: End face / Planfläche



Wear comparison of insert Verschleißvergleich der WSP

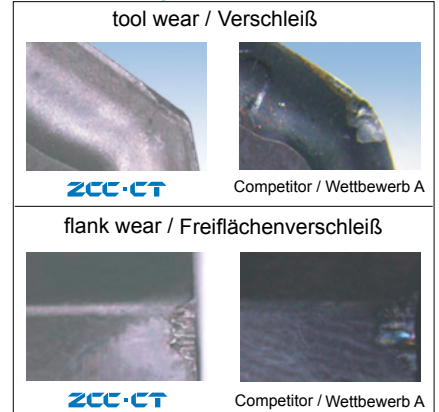

FMA 11 Kr: 45°

New generation of face milling with double sided inserts
 Neue Planfräsergeneration mit doppelseitiger WSP



Double sided inserts
 Doppelseitige WSP

Maximum cutting depth:
 Maximale Schnitttiefe:

a_p max:

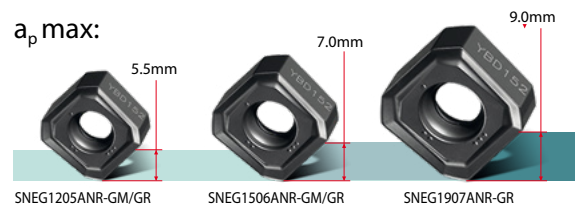

New SNEG1506ANR-E



YBG205

- For machining of stainless steel
- Für die Bearbeitung von rostfreiem Stahl

Inserts with large rake angles,
 reducing power consumption.

Großer Spanwinkel reduziert
 Schnittkräfte.

8 cutting edges

8 Schneidkanten für
 wirtschaftliche
 Auslastung der WSP

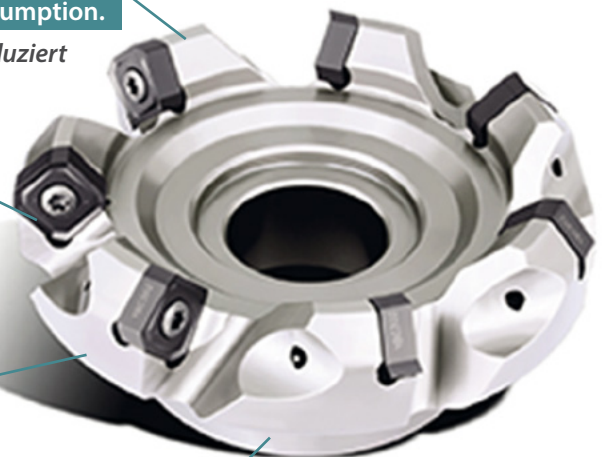

Milling cutter with thicker inserts for high stability
 and deeper cutting depth.

Doppelseitige, extra dicke Wendeschneidplatte für große
 Spantiefen bei hoher Bruchsicherheit.

Inserts with wiper cutting edge for good surface quality.

Wiper-Geometrie für beste Oberflächengüte.

Insert grades:
 WSP Sorten:

YBC302

CVD
 P15 - P35

YBM253

CVD
 P20 - P40

YBG205

PVD
 P15 - P25
 M20 - M30

YB9320

PVD
 P15 - P25
 M20 - M30

YBD152

CVD
 K05 - K25

YBD252

CVD
 K15 - K35

Comparison of wear

Vergleich

Workpiece material: GG30 Grey cast iron
 Werkstück-Material: GG30 Grauguss

Machining: Face milling
 Bearbeitung: Planfräsen

Tool / Werkzeug: FMA11-125-B40-SN12-08

Inserts / WSP: SNEG1205ANR-GM/YBD152

Cutting data: $V_c=300\text{m/min}$ $f_z=0.3\text{ mm/z}$
 Schnittdaten: $a_p=3\text{mm}$ $a_e=80\text{mm}$

	Major cutting edge Hauptschneidkante	Minor Cutting edge Nebenschneidkante	Wiper
FMA11 After 3 Workpieces of machining Nach 3 bearbeiteten Werkstücken			
Competitor / Wettbewerb After 2 Workpieces of machining Nach 3 Bearbeiteten Werkstücken			

Face Milling Tools · Planfräser

Kr:45°

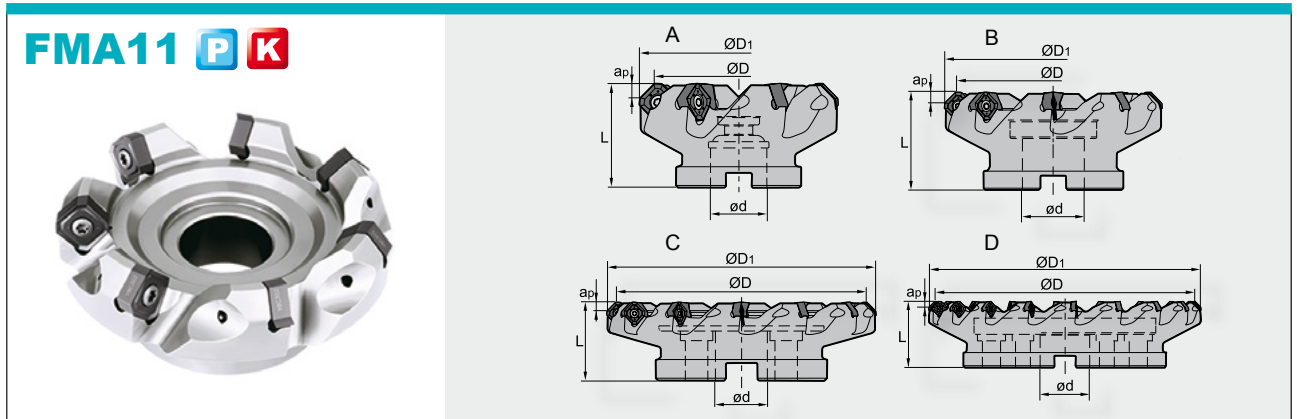





■ Specification of tools · Werkzeug Beschreibung

Type Typ	*	Stock Lager		Dimension (mm) Abmessung					No. of teeth Zähne	Coupling Aufnahme	Weight Gewicht (kg)	
		R	L	ØD	ØD ₁	Ød	L	a _{pmax}				
FMA11	-063-A22-SN12-05	•		63	74.47	22	40	5.5	5	A	0.55	
	-063-A22-SN12-06	•		63	74.47	22	40	5.5	6	A	0.58	
	-080-A22-SN12-08	○		80	74.47	22	40	5.5	6	A	1.10	
	-080-A27-SN12-06	•		80	91.47	27	50	5.5	6	A	1.14	
	-100-B32-SN12-07	•		100	111.47	32	50	5.5	7	B	1.42	
	-100-B32-SN12-07C	*	•		100	111.47	32	50	5.5	7	B	1.42
	-100-B32-SN12-10C	•		100	111.47	32	50	5.5	10	B	1.42	
	-125-B40-SN12-08	•		125	136.47	40	63	5.5	8	B	2.86	
	-125-B40-SN12-08C	*	•		125	136.47	40	63	5.5	8	B	2.86
	-125-B40-SN12-12C	*	•		125	136.47	40	63	5.5	12	B	2.86
	-160-C40-SN12-10	•		160	171.47	40	63	5.5	10	C	4.06	
	-160-C40-SN12-15	•		160	171.47	40	63	5.5	15	C	4.06	
-200-C60-SN12-14	•		200	212.08	60	63	5.5	14	C	6.89		
FMA11	-063-A22-SN15-05	•		63	77.4	22	40	7.0	5	A	0.56	
	-080-A27-SN15-06	•		80	94.4	27	50	7.0	6	A	1.06	
	-100-B32-SN15-07	•		100	114.4	32	50	7.0	7	B	1.47	
	-100-B32-SN15-07C	*	•		100	114.4	32	50	7.0	7	B	1.47
	-100-B32-SN15-09C	*	•		100	114.4	32	50	7.0	9	B	1.47
	-125-B40-SN15-08	•		125	139.4	40	63	7.0	8	B	2.70	
	-125-B40-SN15-08C	*	•		125	139.4	40	63	7.0	8	B	2.70
	-125-B40-SN15-10C	*	•		125	140.25	40	63	7.0	10	B	3.10
	-160-C40-SN15-10	•		160	174.4	40	63	7.0	10	C	3.92	
	-160-C40-SN15-13	•		160	175.25	40	63	7.0	13	C	4.14	
	-200-C60-SN15-12	•		200	214.4	60	63	7.0	12	C	5.46	
	-250-C60-SN15-14	•		250	264.4	60	63	7.0	14	C	11.26	
-315-D60-SN15-18	○		315	329.4	60	80	7.0	18	D	20.00		
FMA11	-125-B40-SN19-07	•		125	142.63	40	63	9.0	7	B	3.00	
	-125-B40-SN19-07C	*	•		125	142.63	40	63	9.0	7	B	3.00
	-160-C40-SN19-09	•		160	167.63	40	63	9.0	9	C	4.25	
	-200-C60-SN19-11	•		200	217.63	60	63	9.0	11	C	6.18	
	-250-C60-SN19-13	•		250	267.63	60	63	9.0	13	C	11.55	
	-315-D60-SN19-16	○		315	332.63	60	80	9.0	16	D	20.90	



• Ex stock / ab Lager ○ On demand / auf Anfrage * With internal cooling · Mit Innenkühlung

Milling Tools
Fräser

Spare Parts · Ersatzteile

Diameter Durchmesser Ø D	Insert WSP	screw Schraube	Wrench Schlüssel	
				
SN12 Ø63 - Ø200	SNEG1205ANR-	I60M3.5x10	--	WT15IS
SN15 Ø63 - Ø315	SNEG1506ANR-	I60M5x13	WT20IT	--
SN19 Ø125 - Ø315	SNEG1907ANR-	I43M6x16	WT25IT	--





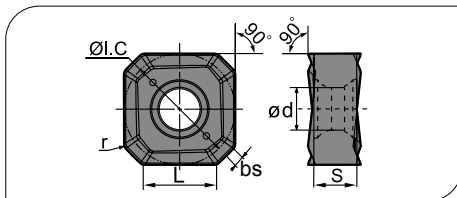

Coupling Aufnahme	Diameter Durchmesser Ø D	Screw-Schraube	Ring-Dichtring
			
B32	Ø100	LDB32C	B32-002-CP
B40	Ø125	LDB40C	B40-002-CP

Applicable inserts · Wendschneidplatten



Workpiece Material Werkstoffe	Ideal Machining Condition Gute Bearbeitungsbedingungen			Normal Machining Condition Normale Bearbeitungsbedingungen			Unfavorable Machining Condition Ungünstige Bearbeitungsbedingungen			
	P	M	K	N	S	P	M	K	N	S
P Steel Stahl	●	●	●	●	●	●	●	●	●	●
M Stainless Steel Rostfreier Stahl	●	●	●	●	●	●	●	●	●	●
K Cast iron Gusseisen	●	●	●	●	●	●	●	●	●	●
N Non-ferrite material Ne Metalle	●	●	●	●	●	●	●	●	●	●
S Heat-resistant steel Warmfester Stahl	●	●	●	●	●	●	●	●	●	●

Insert shape Plattenform	Type Typ	Dimension (mm) Abmessung						CVD Coating CVD Beschicht.						PVD Coating PVD Beschicht.						Cermet Cermet	Carbide uncoat. unbe. Hartmetall							
		L	I.C	S	bs	Ø d	r	YBC302	YBC301	YBC401	YBM253	YBM251	YBM351	YBD152	YBD252	YBG102	YB9320	YBG205	YBG202		YBG212	YBG302	YBG152	YBG252	YNG151	YNG151C	YC30S	YD101
	SNEG1205ANR-GM	7.6	12.0	4.76	1.05	4.6	0.8	●	●	●	●	●	●	●	●	●	●	●	●	●	●	●	●	●	●	●	●	●
	SNEG1506ANR-GM	9.4	15.0	5.54	1.30	5.5	0.9	●	●	●	●	●	●	●	●	●	●	●	●	●	●	●	●	●	●	●	●	●
	SNEG1205ANR-GR	7.6	12.0	4.76	1.05	4.6	0.8	●	●	●	●	●	●	●	●	●	●	●	●	●	●	●	●	●	●	●	●	●
	SNEG1506ANR-GR	9.4	15.0	5.54	1.30	5.5	0.9	●	●	●	●	●	●	●	●	●	●	●	●	●	●	●	●	●	●	●	●	●
	SNEG1907ANR-GR	12.1	19.0	7.0	1.67	7.2	1.0	●	●	●	●	●	●	●	●	●	●	●	●	●	●	●	●	●	●	●	●	●
	SNEG1506ANR-E	9.4	15.0	5.6	1.30	5.5	0.9	●	●	●	●	●	●	●	●	●	●	●	●	●	●	●	●	●	●	●	●	●
	SNEG1205ANR-HGR	7.6	12.0	4.76	1.05	4.6	0.8	●	●	●	●	●	●	●	●	●	●	●	●	●	●	●	●	●	●	●	●	●
	SNEG1506ANR-HGR	9.4	15.0	5.54	1.30	5.5	0.9	●	●	●	●	●	●	●	●	●	●	●	●	●	●	●	●	●	●	●	●	●

● Ex Stock / ab Lager ○ On demand / auf Anfrage

FMA 12 $Kr:45^\circ$

High Performance Face Mill with 16 edges for outstanding economy

Hochleistungs-Planfräser mit 16 Schneidkanten für hervorragende Wirtschaftlichkeit

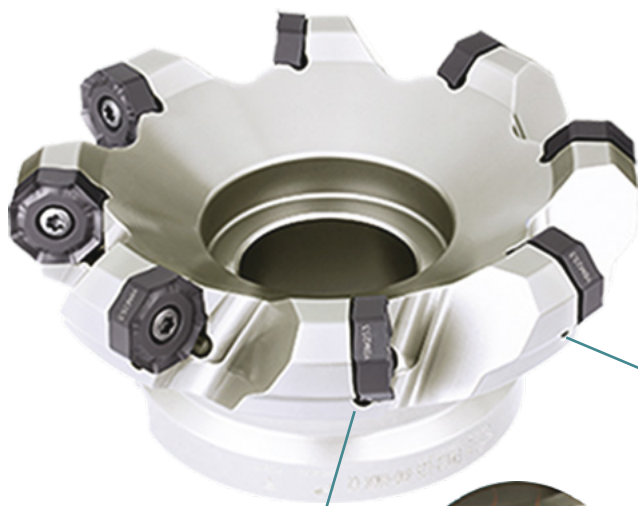

Unique 3-dimensional edge
Einzigartige, dreidimensionale Schneidkante



Maximum cutting depth:
Maximale Schnitttiefe:

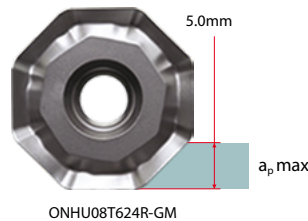

Economy:
Wirtschaftlichkeit:



Double negative rake angle, in combination with helical insert structure, achieves double positive axial angle, which will help reduce cutting resistance and improve chip evacuation.

Doppelt negative Spanwinkel in Kombination mit einer spiralförmigen Struktur führen zu doppelt positiven Achswinkeln, die zu einer Reduzierung des Schneidwiderstandes führen und die Spanabfuhr verbessern.

Smooth cut due to positive and sharp cutting edge.

Weicher Schnitt durch positive und scharfe Schneidkantenausführung.

Comparing of wear Vergleich

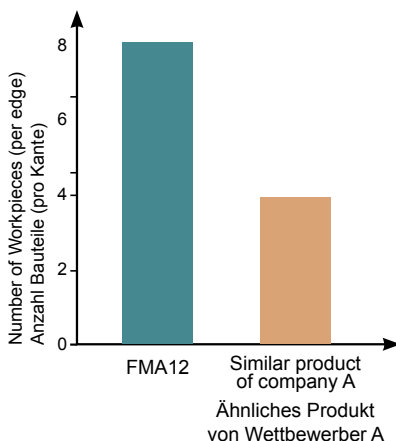

Example

Beispiel

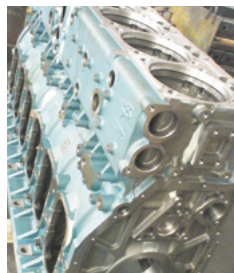

Workpiece : Cylinder
Werkstück: Zylinder

Werkstück Material: HB250 Gray cast iron
Workpiece Material: HB250 Grauguss

Machining: Face milling
Bearbeitung: Planfräsen

Tool / Werkzeug: FMA12-160-C40-ON08-10

Inserts / WSP: ONHU08T624R-GM/YBD152

Cutting data / Schnittdaten: $V_c=150\text{m/min}$ $f_z=0.25\text{ mm/z}$
 $a_p=3\text{mm}$ $a_e=160\text{mm}$

Cooling: External
Kühlung: Außen

Insert grades:
WSP Sorten:

YBM253

YBG205

YBD152

CVD
P20 - P40
M10 - M30

PVD
P10 - P30
M10 - M30

CVD
K05 - K25

Face Milling Tools · Planfräser

Kr:45°



FMA12 **P** **K** **M**

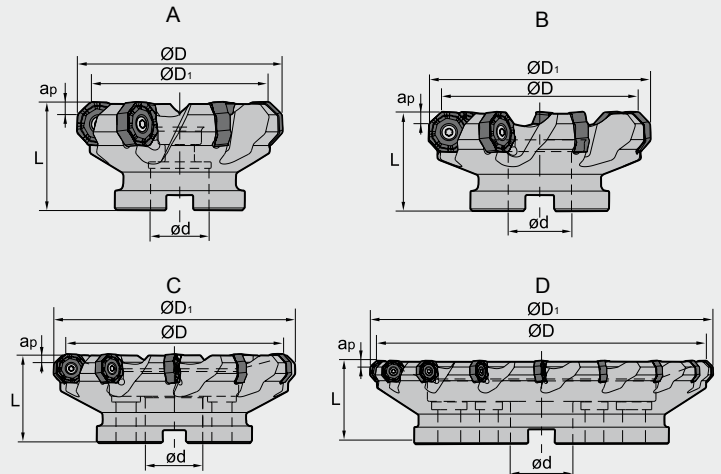

Specification of tools · Werkzeug Beschreibung

Type Typ	Stock Lager	Dimension (mm) Abmessung							No. of teeth Zähne	Coupling Aufnahme	Weight Gewicht (kg)
		R	L	ØD	ØD ₁	Ød	L	a _{pmax}			
FMA12 -063-A22-ON08-05	●			63	78	22	50	5.0	5	A	0.6
-080-A27-ON08-06	●			80	95	27	50	5.0	6	A	0.97
-100-B32-ON08-07	●			100	115	32	50	5.0	7	B	1.28
-100-B32-ON08-07C	●*			100	115	32	50	5.0	7	B	1.28
-125-B40-ON08-08	●			125	140	40	63	5.0	8	B	2.59
-125-B40-ON08-08C	●*			125	140	40	63	5.0	8	B	2.59
-160-C40-ON08-10	●			160	175	40	63	5.0	10	C	4.10
-200-C60-ON08-12	○			200	215	60	63	5.0	12	C	5.68
-250-C60-ON08-14	○			250	265	60	63	5.0	14	C	11.90
-315-D60-ON08-18	○			315	330	60	80	5.0	18	D	20.41

● Ex stock / ab Lager ○ On demand / auf Anfrage * With internal cooling · Mit Innenkühlung

Spare Parts · Ersatzteile

Diameter Durchmesser Ø D	Insert WSP	Screw Schraube	Drehmoment Torque	Wrench Schlüssel
Ø80-Ø315	ONHU08T624R-GM	I60M5X13	5 Nm	WT20IT

We recommend to use torque wrenches · Wir empfehlen den Einsatz von Drehmomentschlüsseln

Coupling Aufnahme	Diameter Durchmesser Ø D	Screw-Schraube	Ring-Dichtring
B32	Ø100	LDB32C	B32-002-CP
B40	Ø125	LDB40C	B40-002-CP

Applicable inserts · Wendeschneidplatten

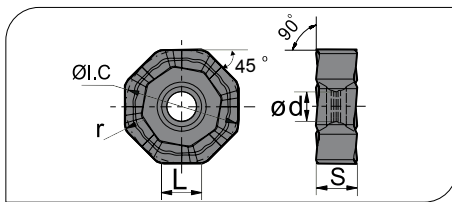

Workpiece Material Werkstoffe	Ideal Machining Condition Gute Bearbeitungsbedingungen			Normal Machining Condition Normale Bearbeitungsbedingungen			Unfavorable Machining Condition Ungünstige Bearbeitungsbedingungen		
	●	●	●	●	●	●	●	●	●
P Steel Stahl	●	●	●	●	●	●	●	●	●
M Stainless Steel Rostfreier Stahl	●	●	●	●	●	●	●	●	●
K Cast iron Gusseisen				●	●	●	●	●	●
N Non-ferrous material Nichtmetalle									●
S Heat-resistant steel Wärmefester Stahl				●	●	●	●	●	●

Insert shape Plattenform	Type Typ	Dimension (mm) Abmessung					CVD Coating CVD Beschicht.						PVD Coating PVD Beschicht.				Cermet Cemet	Carbide uncoat. unbe. Hartmetall									
		L	I.C	S	Ø d	r	YBC302	YBC301	YBC401	YBM253	YBM251	YBM351	YBD152	YBD252	YBG102	YB9320	YBG205	YBG202	YBG212	YBG302	YBG152	YBG252	YNG151	YNG151C	YC30S	YD101	YD201
	ONHU08T624R-GM	6.38	20.2	6.3	5.3	2.4				●		●				●											

Recommended cutting data · Empfohlene Schnittdaten

Workpiece material Werkstückstoff	Hardness HB Härte	Grade Sorte	Cutting data Schnittdaten		
			V (m/min)	f (mm/z)	a _p max
P Low-carbon steel Soft steel Niedriglegierter Kohlenstoffstahl	≤180	YBM253	270 (220-350)	0.2 (0.1-0.3)	5
		YBG205			
P Alloy tool steel Leg. Werkzeugstahl	180-350	YBM253	240 (180-320)	0.15 (0.1-0.3)	5
		YBG205			
M Stainless steel Rostfreier Stahl	≤270	YBM253	230 (180-300)	0.15 (0.1-0.3)	5
		YBG205	160 (110-270)		
K Cast iron Gusseisen	180-250	YBD152	270 (150-300)	0.2 (0.1-0.3)	5

● Ex Stock / ab Lager ○ On demand / auf Anfrage

FMD02



Clamping by wedge for highest accuracy and reliability.

Klemmkeilspannung für höchste Stabilität und Wiederholgenauigkeit.

Machining of cast iron
Gussbearbeitung
 $a_{p\ max}=5\ mm$

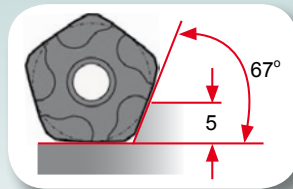

Steel, Alloy steel
Stahl, Legierter Stahl
 $a_{p\ max}=7.5\ mm$

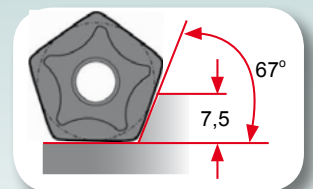

Holder/ Halter	FMD02-100-B32-PN11-10 ZCC-CT	Competitor A / Wettbewerber A
Insert/ WSP	PNEG110512R-CR/YBD152	
Cutting data Schnittdaten	D=100 mm $a_p=3\sim5\ mm$ Vc=243 m/min $f_z=0.15\ mm/Z$ 145~155 pcs /Stück	D=100 mm $a_p=3\sim5\ mm$ Vc=243 m/min $f_z=0.12\ mm/Z$ 120~133 pcs /Stück

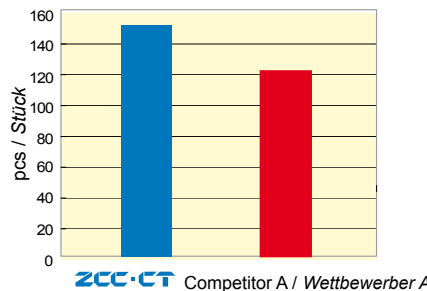
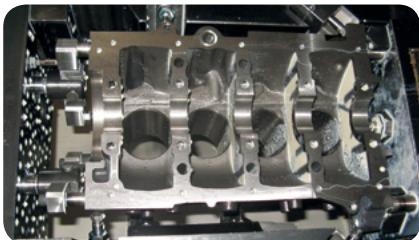

Comparison of wear / Verschleißvergleich

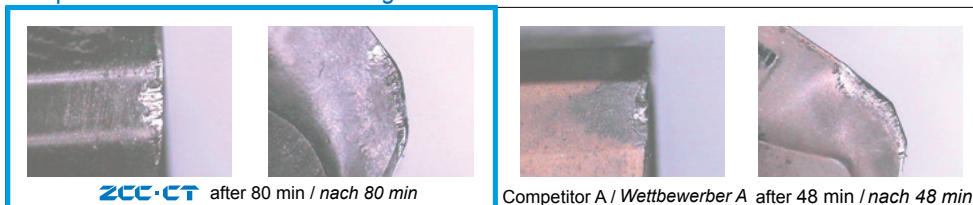

Face milling / Planfräser

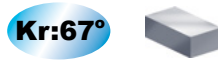

FMD02 **P** **K**

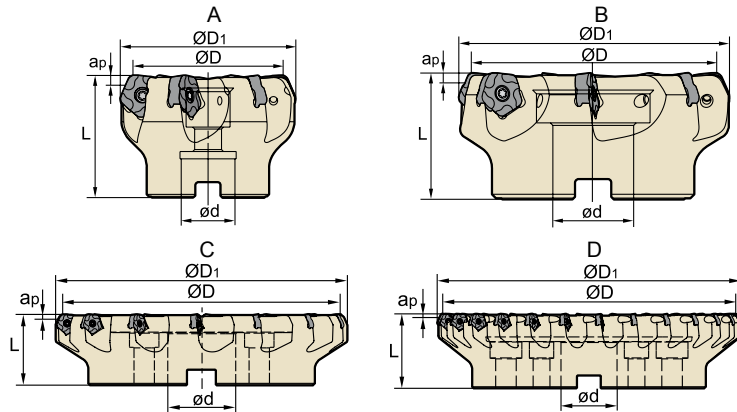

Type Typ	Stock Lager	Dimension Abmessung (mm)							Tooth Zähne Z	Coupling Aufnahme	Weight Gewicht (kg)
		R	L	ØD	ØD ₁	ød	L	a _{pmax}			
FMD02 -050-A22-PN11-04	● ●	50	60.1	22	50	5	4	A	0.6		
-050-A22-PN11-04C	* ○ ○	50	60.1	22	50	5	4	A	0.6		
-050-A22-PN11-05	● ○	50	60.1	22	50	5	5	A	0.6		
-050-A22-PN11-05C	* ● ○	50	60.1	22	50	5	5	A	0.6		
-063-A22-PN11-05	● ○	63	73.1	22	50	5	5	A	0.8		
-063-A22-PN11-05C	* ● ○	63	73.1	22	50	5	5	A	0.8		
-063-A22-PN11-06	● ○	63	73.1	22	50	5	6	A	0.9		
-063-A22-PN11-06C	* ● ○	63	73.1	22	50	5	6	A	0.9		
-080-A27-PN11-06	● ○	80	90.1	27	50	5	6	A	1.1		
-080-A27-PN11-06C	* ● ○	80	90.1	27	50	5	6	A	1.1		
-080-A27-PN11-08	● ○	80	90.1	27	50	5	8	A	1.2		
-080-A27-PN11-08C	* ● ○	80	90.1	27	50	5	8	A	1.2		
-100-B32-PN11-07	● ○	100	110.1	32	50	5	7	B	1.8		
-100-B32-PN11-07C	* ● ○	100	110.1	32	50	5	7	B	1.8		
-100-B32-PN11-10	● ○	100	110.1	32	50	5	10	B	1.9		
-100-B32-PN11-10C	* ● ○	100	110.1	32	50	5	10	B	1.9		
-125-B40-PN11-08	● ○	125	135.1	40	63	5	8	B	2.9		
-125-B40-PN11-08C	* ○ ○	125	135.1	40	63	5	8	B	2.9		
-125-B40-PN11-12	● ○	125	135.1	40	63	5	12	B	3.2		
-125-B40-PN11-12C	* ● ○	125	135.1	40	63	5	12	B	3.2		
-160-B40-PN11-10	● ○	160	170.1	40	63	5	10	B	5.6		
-160-B40-PN11-14	● ○	160	170.1	40	63	5	14	B	6.4		
-200-C60-PN11-12	○ ○	200	210.1	60	63	5	12	C	7.9		
-200-C60-PN11-16	● ○	200	210.1	60	63	5	16	C	8.5		
-200-C60-PN11-20	○ ○	200	210.1	60	63	5	20	C	8.5		
-200-C60-PN11-24	● ○	200	210.1	60	63	5	24	C	8.6		
-250-C60-PN11-14	○ ○	250	260.1	60	63	5	14	C	13.4		
-250-C60-PN11-18	● ○	250	260.1	60	63	5	18	C	18.0		
-250-C60-PN11-30	○ ○	250	260.1	60	63	5	30	C	13.5		
-315-D60-PN11-26	● ○	315	325.1	60	80	5	26	D	24.5		

■ Spare Parts · Ersatzteile

ØD	Screw / Schraube	Wrench / Schlüssel
	Ø50 -Ø315	I60M4×10

Coupling Aufnahme	Diameter Durchmesser Ø D	Screw-Schraube	Ring-Dichtring
		B32	Ø100
B40	Ø125	LDB40C	B40-002-CP

● Ex Stock / ab Lager ○ On demand / auf Anfrage * With internal cooling · Mit Innenkühlung

Milling · Fräsen

Indexable Milling Tools · Wendeplattenfräser

Face Milling Tools · Planfräser

Kr:67°



FMD02 P K

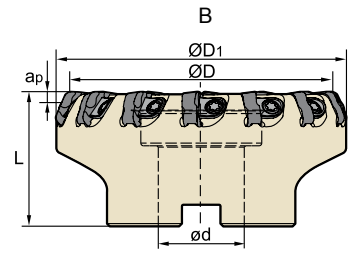
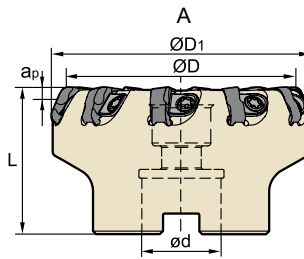

Type Typ	Stock Lager	Dimension Abmessung (mm)							Tooth Zähne Z	Coupling Aufnahme	Weight Gewicht (kg)
		R	L	ØD	ØD ₁	ød	L	a _{pmax}			
FMD02		●	○	80	90.1	27	50	5	10	A	1.3
	*	○	○	80	90.1	27	50	5	10	A	1.3
		●	○	100	110.1	32	50	5	14	B	1.6
	*	●	○	100	110.1	32	50	5	14	B	1.6
		●	○	125	135.1	40	63	5	18	B	3.2
	*	○	○	125	135.1	40	63	5	18	B	3.2
		●	○	160	170.1	40	63	5	22	B	5.8
		●	○	200	210.1	60	63	5	28	C	8.5
		○	○	200	210.1	60	63	5	36	C	8.5

● Ex stock / ab Lager ○ On demand / auf Anfrage * With internal cooling · Mit Innenkühlung

Spare Parts · Ersatzteile

ØD	Wedge / Keil	Screw / Schraube	Wrench / Schlüssel
Ø80 - Ø200	W18N	DM6×20A	WT15IT

Coupling Aufnahme	Diameter Durchmesser Ø D	Screw-Schraube	Ring-Dichtring
		B32	-
B40	Ø125	LDB40C	B40-002-CP



B

Milling Tools
Fräser

Applicable inserts Wendschneidplatten

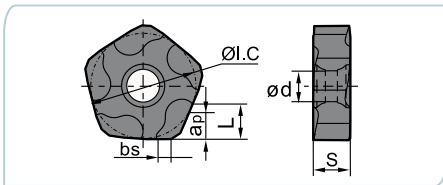

Workpiece Material Werkstoffe	Ideal Machining Condition Gute Bearbeitungsbedingungen			Normal Machining Condition Normale Bearbeitungsbedingungen			Unfavorable Machining Condition Ungünstige Bearbeitungsbedingungen		
	P	M	K	P	M	K	P	M	K
P Steel Stahl	●	●	●	●	●	●	●	●	●
M Stainless Steel Rostfreier Stahl	●	●	●	●	●	●	●	●	●
K Cast iron Gusseisen	●	●	●	●	●	●	●	●	●
N Non-ferrous material Nichtmetalle	●	●	●	●	●	●	●	●	●
S Heat-resistant steel Wärmefester Stahl	●	●	●	●	●	●	●	●	●

WSP Insert	Typ Type	Dimension Abmessung (mm)						CVD Coating CVD Beschicht.						PVD Coating PVD Beschicht.						Cermet Cermet	Carbide uncoat. unabh. Hartmetall						
		L	ØI.C	S	ød	bs	a _{p max}	YBC302	YBC301	YBC401	YBM253	YBM251	YBM351	YBD152	YBD252	YBG102	YB9320	YBG205	YBG202			YBG212	YBG302	YBG152	YBG252		
	PNEG110512R-CF	5.4	15.875	5.56	4.64	1.6	5								●												
	PNEG110512L-CF	5.4	15.875	5.56	4.64	1.6	5								○												
	PNEG110512R-CM	5.4	15.875	5.56	4.64	1.6	5								●												
	PNEG110512L-CM	5.4	15.875	5.56	4.64	1.6	5								○												
	PNEG110512R-CR	5.4	15.875	5.56	4.64	1.6	5								● ●												
	PNEG110512L-CR	5.4	15.875	5.56	4.64	1.6	5								●												

Applicable inserts Wendschneidplatten

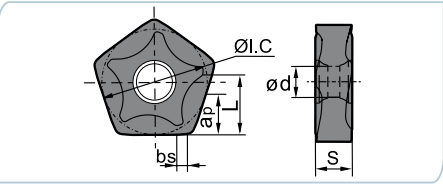

Workpiece Material Werkstoffe	Ideal Machining Condition Gute Bearbeitungsbedingungen			Normal Machining Condition Normale Bearbeitungsbedingungen			Unfavorable Machining Condition Ungünstige Bearbeitungsbedingungen		
	P	M	K	P	M	K	P	M	K
P Steel Stahl	●	●	●	●	●	●	●	●	●
M Stainless Steel Rostfreier Stahl	●	●	●	●	●	●	●	●	●
K Cast iron Gusseisen	●	●	●	●	●	●	●	●	●
N Non-ferrous material Nichtmetalle	●	●	●	●	●	●	●	●	●
S Heat-resistant steel Wärmefester Stahl	●	●	●	●	●	●	●	●	●

WSP Insert	Typ Type	Dimension Abmessung (mm)						CVD Coating CVD Beschicht.						PVD Coating PVD Beschicht.						Cermet Cermet	Carbide uncoat. unabh. Hartmetall						
		L	ØI.C	S	ød	bs	a _{p max}	YBC302	YBC301	YBC401	YBM253	YBM251	YBM351	YBD152	YBD252	YBG102	YB9320	YBG205	YBG202			YBG212	YBG302	YBG152	YBG252		
	PNEG110512R-PF	7.5	15.875	5.56	4.64	1.6	7.5	●			○																
	PNEG110512L-PF	7.5	15.875	5.56	4.64	1.6	7.5	○																			
	PNEG110512R-PM	7.5	15.875	5.56	4.64	1.6	7.5	●			●																
	PNEG110512L-PM	7.5	15.875	5.56	4.64	1.6	7.5	○			○																
	PNEG110512R-PR	7.5	15.875	5.56	4.64	1.6	7.5	○			●																
	PNEG110512L-PR	7.5	15.875	5.56	4.64	1.6	7.5	○			○																

Cutting Data / Schnittdaten

Workpiece material Werkstück Material	Hardness HB Härte	Grade Sorte	Cutting data / Schnittdaten												
			V _c (m/min)	f _z (mm/z)			a _{p max} (mm)								
				PF	PM	PR									
P Low-carbon steel Soft steel Niedriglegierter Kohlenstoffstahl Baustahl	≤180	YBM253 YBC302	270 (220-350)	0.15 (0.1-0.2)	0.2 (0.1-0.3)	0.3 (0.2-0.4)	7.5								
								P High-carbon steel Alloy steel Hochleg. Kohlenstoffstahl	180-280	YBM253 YBC302	260 (200-320)	0.15 (0.1-0.2)	0.2 (0.1-0.3)	0.3 (0.2-0.4)	7.5
K Cast iron Gusseisen	180-250	YBD152	270 (150-300)	CF	CM	CR	5								
				0.15 (0.1-0.2)	0.2 (0.1-0.3)	0.3 (0.2-0.4)									

● Ex Stock / ab Lager ○ On demand / auf Anfrage

Face Milling Tools · Planfräser

Kr:55°





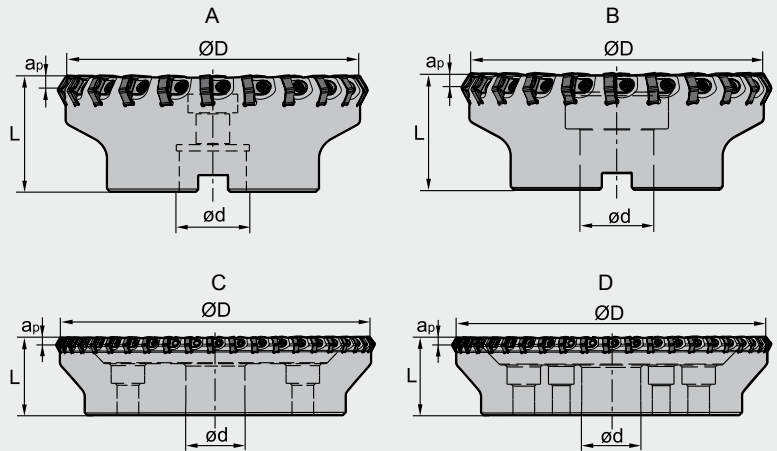

FMD02



Specification of tools · Werkzeug Beschreibung

Type Typ	Stock Lager		Dimension (mm) Abmessung				No. of teeth Zähne	Coupling Aufnahme	Weight Gewicht (kg)
	R	L	ØD	ød	L	apmax			
FMD02 -080-A27-HN09-08	○		80	27	50	6	8	A	1.19
-080-A27-HN09-10	○	○	80	27	50	6	10	A	1.1
-100-B32-HN09-10	○		100	32	50	6	10	B	1.77
-100-B32-HN09-14	○	○	100	32	63	6	14	B	2.6
-125-B40-HN09-14	○		125	40	63	6	14	B	3.55
-125-B40-HN09-18	○	○	125	40	63	6	18	B	3.7
-160-B40-HN09-18	○		160	40	63	6	18	B	5.62
-160-B40-HN09-22	○	○	160	40	63	6	22	B	5.6
-200-C60-HN09-22	○		200	60	63	6	22	C	6.7
-200-C60-HN09-28	○	○	200	60	63	6	28	C	6.3
-250-C60-HN09-28	○		250	60	63	6	28	C	13
-250-C60-HN09-36	○	○	250	60	63	6	36	C	10.3
-315-C60-HN09-32	○		315	60	63	6	32	C	21.7
-315-C60-HN09-44	○		315	60	63	6	44	C	21.7
-315-D60-HN09-44	○	○	315	60	63	6	44	D	21.7

Spare Parts · Ersatzteile

Diameter Durchmesser Ø D	Wedge Keil	Wedge screw Keilschraube	Wrench Schlüssel	
Ø80-Ø315	 W18N	 DM6×20A	 WT15IT	

Applicable inserts - Wendeschneidplatten

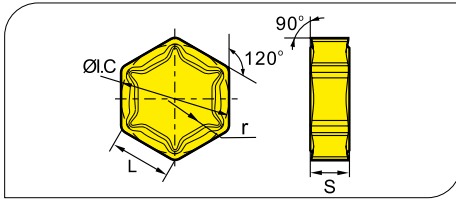

Workpiece Material Werkstoffe	Ideal Machining Condition Gute Bearbeitungsbedingungen			Normal Machining Condition Normale Bearbeitungsbedingungen			Unfavorable Machining Condition Ungünstige Bearbeitungsbedingungen		
	P	M	K	P	M	K	P	M	K
P Steel Stahl	●	●	●	●	●	●	●	●	●
M Stainless Steel Rostfreier Stahl	●	●	●	●	●	●	●	●	●
K Cast iron Gusseisen	●	●	●	●	●	●	●	●	●
N Non-ferrous material Nichte Metalle	●	●	●	●	●	●	●	●	●
S Heat-resistant steel Wärmefester Stahl	●	●	●	●	●	●	●	●	●

Insert WSP	Type Typ	Dimensions (mm) Abmessungen				CVD Coating CVD Beschicht.							PVD Coating PVD Beschicht.					Cermet Cermet	Carbide uncoat. unbe. Hartmetall									
		L	I.C.	S	R	YBC302	YBC301	YBC401	YBM253	YBM251	YBM351	YBD152	YBD252	YBG102	YB9320	YBG205	YBG202		YBG212	YBG302	YBG152	YBG252	YNG151	YNG151C	YC30S	YD101	YD201	
	HNEX090512-DF	9.16	15.875	5.56	1.2							○																
	HNEX090512-DM	9.16	15.875	5.56	1.2							○																
	HNEX090512-DR	9.16	15.875	5.56	1.2						●	●																
	HNGX090516-MR	9.16	15.875	5.56	1.6						●																	
	HNGX090520-MR	9.16	15.875	5.56	2.0						●																	
	HNGX090530-HDR	9.16	15.875	5.56	3.0						●																	

Chipbreaker Selection FMD02 - Spanbrecher Auswahl FMD02

Application Anwendung	Finishing Schlichten	Semi-Finishing Mittlere Bearbeitung	Roughing Schruppen
K	-DF	-DM	-DR

Recommended cutting data - Empfohlene Schnittdaten

Workpiece material Werkstückstoff	Hardness HB Härte	Grade Sorte	Cutting data Schnittdaten			
			V (m/min)	f (mm/z)		
				-DF	-DM	-DR
K Cast iron Gusseisen	180-250	YBD152	180 (110-250)	0.15(0.1-0.2)	0.2 (0.1-0.3)	0.3(0.2-0.5)
		YBD252	130 (110-200)	0.2(0.1-0.2)	0.25 (0.1-0.3)	0.3(0.2-0.5)

● Ex Stock / ab Lager ○ On demand / auf Anfrage

Face Milling Tools · Planfräser

Kr:90°



FMP12 **P** **K**

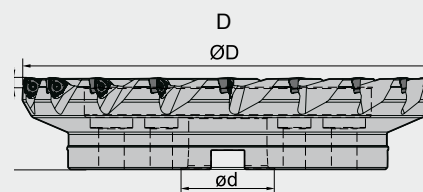
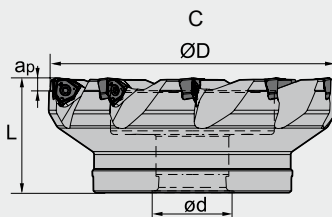
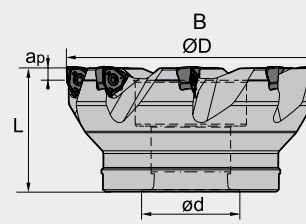
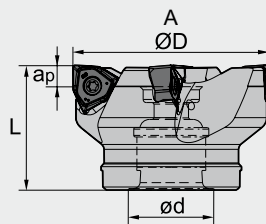

Specification of tools · Werkzeug Beschreibung

Type Typ	*	Stock Lager		Dimension (mm) Abmessung (mm)				No. of teeth Zähne	Coupling Aufnahme	Weight Gewicht (kg)
		R	L	ØD	Ød	L	a _{pmax}			
FMP12										
FMP12-050-A22-WN06-05C	*	○		50	22	40	5.7	5	A	0.55
FMP12-063-A22-WN06-06C	*	●		63	22	40	5.7	6	A	0.45
FMP12-080-A27-WN06-07C	*	●		80	27	40	5.7	7	A	1.0
FMP12-100-B32-WN06-09		●		100	32	50	5.7	9	A	1.4
FMP12-100-B32-WN06-09C	*	●		100	32	50	5.7	9	A	1.4
FMP12-125-B40-WN06-11C	*	●		125	40	63	5.7	11	B	3.4
FMP12-160-C40-WN06-14		●		160	40	63	5.7	14	C	5.4
FMP12-063-A22-WN08-04C	*	●		63	22	40	7.7	4	A	0.39
FMP12-063-A22-WN08-05C	*	●		63	27	40	7.7	5	A	0.45
FMP12-080-A27-WN08-05C	*	●		80	27	50	7.7	5	A	0.95
FMP12-100-B32-WN08-06		●		100	32	50	7.7	6	B	1.32
FMP12-100-B32-WN08-06C	*	●		100	32	63	7.7	6	B	1.32
FMP12-125-B40-WN08-08C	*	●		125	40	63	7.7	8	B	3.3
FMP12-160-C40-WN08-10		○		160	40	63	7.7	10	C	5.2
FMP12-200-C60-WN08-12		○		200	60	63	7.7	12	C	-
FMP12-250-C60-WN08-14		○		250	60	63	7.7	14	C	-
FMP12-315-D60-WN08-18		○		315	60	70	7.7	18	D	-

● Ex stock / ab Lager ○ On demand / auf Anfrage * With internal cooling · Mit Innenkühlung

Spare Parts · Ersatzteile

Diameter Durchmesser Ø D	Insert WSP	Screw Schraube	Drehmoment Torque	Wrench Schlüssel	
Ø50-Ø160	 WNHU06**	 I60M3X9	1.8 Nm	 WT09IS	
Ø63-Ø315	 WNHU08**	 I60M4X10	3.4 Nm	 WT15IP	

We recommend to use torque wrenches · Wir empfehlen den Einsatz von Drehmomentschlüsseln

Coupling Aufnahme	Diameter Durchmesser Ø D	Screw-Schraube	Ring-Dichtring
B32	Ø100	 LDB32C	 B32-002-CP
B40	Ø125	 LDB40C	 B40-002-CP

Milling · Fräsen

Indexable Milling Tools · Wendeplattenfräser

Face Milling Tools · Planfräser

Kr:90°

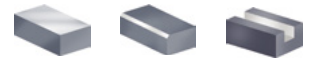

FMP12 **P** **K**



Weldon shank
Weldon-Schaft

■ Specification of tools · Werkzeug Beschreibung

Type Typ	*	Stock Lager		Dimension (mm) Abmessung (mm)					No. of teeth Zähne	Coupling Aufnahme	Weight Gewicht (kg)
		R	L	ØD	Ød	L	L ₁	a _p max			
FMP12 025-XP25-WN06-02C	*	•		25	25	100	30	5,7	2	HB	0.38
032-XP25-WN06-03C	*	•		32	25	120	40	5,7	3	HB	0.47
040-XP32-WN06-04C	*	•		40	32	140	40	5,7	4	HB	0.85
050-XP40-WN06-05C	*	•		50	40	169	40	5,7	5	HB	1.59

• Ex stock / ab Lager ○ On demand / auf Anfrage * With internal cooling · Mit Innenkühlung

■ Spare Parts · Ersatzteile

Diameter Durchmesser Ø D	Insert WSP	Screw Schraube	Drehmoment Torque	Wrench Schlüssel	
Ø25-Ø50	WNHU06**	I60M3×9	1,8 Nm	WT09IS	

We recommend to use torque wrenches · Wir empfehlen den Einsatz von Drehmomentschlüsseln

B

Milling Tools
Fräser

Applicable inserts · Wendeschneidplatten

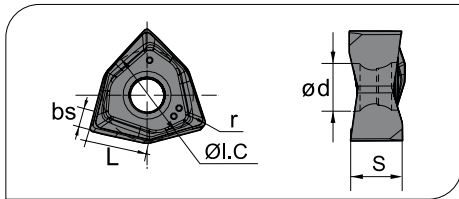

Workpiece Material Werkstoffe	Ideal Machining Condition Gute Bearbeitungsbedingungen			Normal Machining Condition Normale Bearbeitungsbedingungen			Unfavorable Machining Condition Ungünstige Bearbeitungsbedingungen			
	P	M	K	N	S	P	M	K	N	S
P Steel Stahl	●	●	●	●	●	●	●	●	●	●
M Stainless Steel Rostfreier Stahl	●	●	●	●	●	●	●	●	●	●
K Cast iron Gusseisen						●	●	●	●	●
N Non-ferrous material N-Metalle									●	●
S Heat-resistant steel Warmfester Stahl						●	●	●	●	●

Insert shape Plattenform	Type Typ	Dimension (mm) Abmessung						CVD Coating CVD Beschicht.						PVD Coating PVD Beschicht.						Cermets Cermet	Carbide uncoat. unbe. Hartmetall							
		L	I.C.	S	bs	Ø d	r	YBC302	YBC301	YBC401	YBM253	YBM251	YBM351	YBD152	YBD252	YBG102	YBG320	YBG205	YBG202			YBG212	YBG302	YBG152	YBG252	YNG151	YNG151C	YC30S
	WNHU060404PNR-GM	5.7	9.525	4	1.35	3.5	0.4				●		●				●											
	WNHU060408PNR-GM	5.7	9.525	4	1.35	3.5	0.8				●		●	●			●											

Cutting Data / Schnittdaten

Workpiece material Werkstück Material	Hardness HB Härte	Grade Sorte	Cutting data / Schnittdaten		
			V _c (m/min)	f _z (mm/z)	a _{pmax} (mm)
P Low-carbon steel Soft steel Niedriglegierter Kohlenstoffstahl Baustahl	≤180	YBM253	270 (220-350)	0.2 (0.1-0.4)	7.5
		YBG205			
		High-carbon steel Alloy steel Hochleg. Kohlenstoffstahl			
Alloy tool steel Leg. Werkzeugstahl	280-350	YBM253	240 (180-300)	0.2 (0.1-0.4)	7.5
K Cast iron Gusseisen	180-250	YBD152	270 (150-300)	0.2 (0.1-0.4)	5

● Ex Stock / ab Lager ○ On demand / auf Anfrage

Face Milling Tools · Planfräser



EMP01

P

K

M

Weldon shank
Weldon-Schaft

Straight shank
Zylinder-Schaft

Weldon shank
Weldon-Schaft

Straight shank
Zylinder-Schaft

Specification of tools · Werkzeug Beschreibung

Type Typ	*	Stock Lager		Dimension (mm) Abmessung					No. of teeth Zähne	Coupling Aufnahme	Weight Gewicht (kg)
		R	L	ØD	Ød	L	L ₁	a _{pmax}			
EMP01 Weldon shank Weldon-Schaft	*	•		19,9	20	30	100	6,4	2	HB	0.31
	*	•		25	20	35	115	6,4	3	HB	0.61
EMP01 straight shank zylinder-Schaft	*	•		12	12	25	75	6,4	2	HA	0.31
	*	•		14	16	25	85	6,4	3	HA	0.61
	*	•		16	16	30	90	6,4	4	HA	0.75

• Ex stock / ab Lager ◦ On demand / auf Anfrage * With internal cooling · Mit Innenkühlung

Spare Parts · Ersatzteile

Diameter Durchmesser Ø D	Insert WSP	Screw Schraube	Drehmoment Torque	Wrench Schlüssel	
Ø12-Ø25	 APKT070204APM	 I60M1.8x4	0,3 Nm	 WT051P	

We recommend to use torque wrenches · Wir empfehlen den Einsatz von Drehmomentschlüsseln

Face Milling Tools · Planfräser

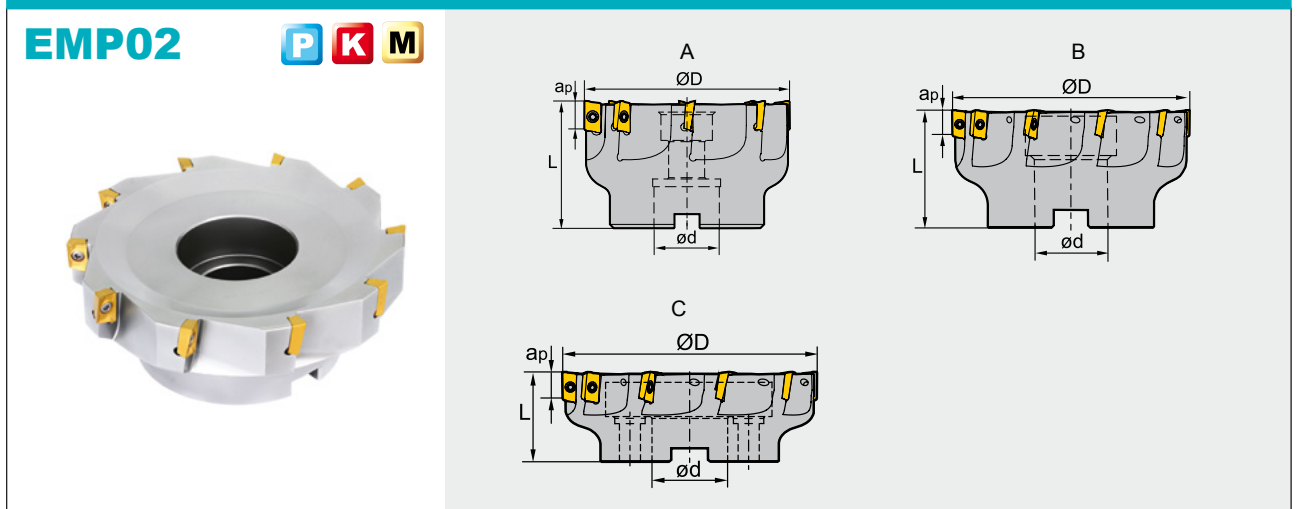



Specification of tools · Werkzeug Beschreibung

Type Typ	*	Stock Lager		Abmessung				No. of teeth Zähne	Coupling Aufnahme	Weight Gewicht (kg)
		R	L	ØD	ød	L	a _p max			
EMP02 EMP02-032-A16-AP07-08C	*	•		32	16	35	6,4	8	A	0.34
EMP02-040-A16-AP07-10C	*	•		40	16	40	6,4	10	A	0.40
EMP02-050-A22-AP07-12C	*	•		50	22	40	6,4	12	A	0.60

• Ex stock / ab Lager ◦ On demand / auf Anfrage * With internal cooling · Mit Innenkühlung

Spare Parts · Ersatzteile

Diameter Durchmesser Ø D	Insert WSP	Screw Schraube	Drehmoment Torque	Wrench Schlüssel
Ø32-Ø050	 APKT070204APM	 I60M1.8x4	0,5 Nm	 WT051P

We recommend to use torque wrenches · Wir empfehlen den Einsatz von Drehmomentschlüsseln

Applicable inserts - Wendeschneidplatten

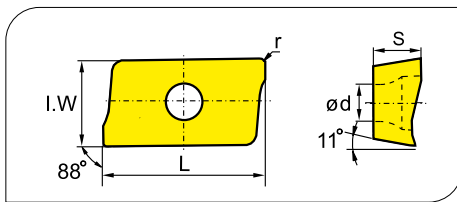

Workpiece Material Werkstoff	Steel Stahl	Stainless Steel Rostfreier Stahl	Cast iron Gusseisen	Non-ferrous material Nichtmetalle	Heat-resistant steel Wärmefester Stahl
P	●	●	●	●	●
M	●	●	●	●	●
K	●	●	●	●	●
N	●	●	●	●	●
S	●	●	●	●	●

Insert shape Plattenform	Type Typ	Dimension (mm) Abmessung					CVD Coating CVD Beschicht.						PVD Coating PVD Beschicht.				Cermet Cermet	Carbide uncoat. unbe. Hartmetall										
		L	I.W	S	Ø d	r	YBC302	YBC301	YBC401	YBM253	YBM251	YBM351	YBD152	YBD252	YBG102	YB9320	YBG205	YBG202	YBG212	YBG302	YBG152	YBG252	YNG151	YNG151C	YC30S	YD101	YD201	
	APKT070204APM	7,32	4,34	2,38	2	0.4									●													

Recommended cutting data - Empfohlene Schnittdaten

Workpiece material Werkstückstoff	Hardness HB Härte	Grade Sorte	Cutting data Schnittdaten		
			V (m/min)	f (mm/z)	a _p max
P Low-carbon steel Soft steel Niedriglegierter Kohlenstoffstahl	≤180	YB9320	240 (220-350)	0.15 (0.05-0.25)	6.4
	180-350		200 (180-320)	0.10 (0.05-0.25)	6.4
M Stainless steel Rostfreier Stahl	≤270		160 (110-270)	0.12 (0.05-0.25)	6.4
	180-250		220 (150-300)	0.15 (0.05-0.25)	6.4

● Ex Stock / ab Lager ○ On demand / auf Anfrage

EMP13 $Kr=90^\circ$

Achieving 90° with high quality Square Shoulder Milling Tools

Erreichen Sie 90° mit der neuen Eckfräuserie

The PVD coating of the tools leads to a longer tool life.

Eine PVD-Beschichtung auf dem Fräser erzielt eine höhere Lebensdauer der Trägerwerkzeuge.

Extra thick inserts with a positive soft cutting geometry reduces the cutting resistance and improves the wear resistance at the same time.

Extra dicke Wendeschneidplatte mit einer positiv weich schneidenden Geometrie reduziert den Schneidwiderstand bei gleichzeitiger Verbesserung der Bruchfestigkeit.

Specially designed cutting edges with high precision control can achieve high quality 90° square shoulder milling.

Speziell entwickelte Schneidkanten mit hoher Präzisionskontrolle für qualitativ hochwertiges 90° Eckfräser.

Maximum cutting depth:
Maximale Schnitttiefe:

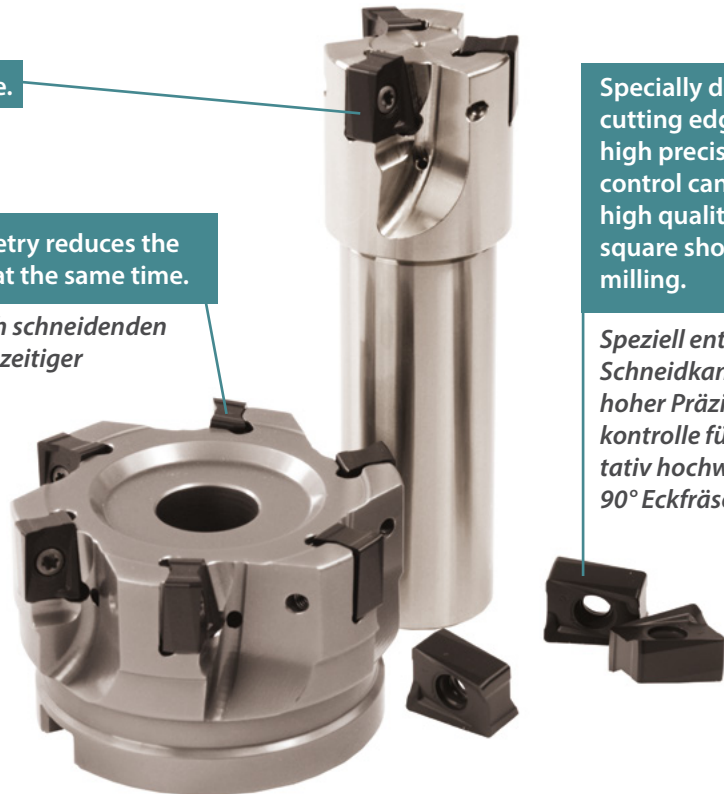
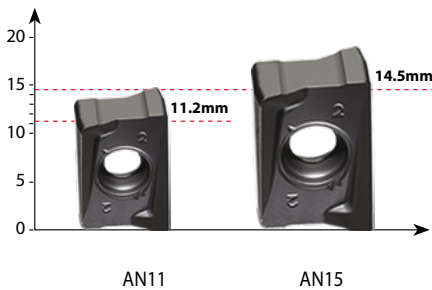

Insert grades:
WSP Sorten:

YBC302

CVD
K05 - K25
P20 - P40

YBM253

CVD
P20 - P40
M10 - M30

YB9320

PVD
P10 - P30
M20 - M30

YBG205

PVD
P10 - P30
M20 - M30

YBD152

CVD
K05 - K25

YBD252

CVD
K15 - K35

YD101

-
K05 - K25

YBG101

PVD
K05 - K25

Comparison of surface quality:
Vergleich der Oberflächengüte:

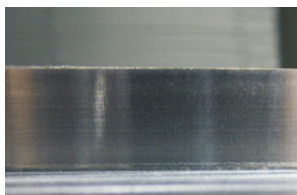

EMP13

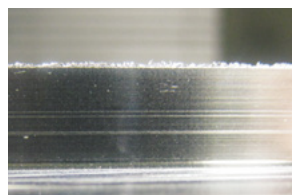

Wettbewerber A

Beispiel / Example:

Workpiece Material: Mold Steel (HRC36)
Werkstück Material: Gesenkstahl (HRC36)
Tool / Werkzeug: EMP13-032-G32-AN15-02
Inserts / WSP: ANGX150608PNR-GM/YBG205
Cutting data / Schnittdaten: $V_c=220\text{m/min}$, $f_z=0.1\text{mm/z}$, $a_p=14.5\text{mm}$, $a_e=10\text{mm}$
Cutting condition: Dry cutting
Schnittbedingungen: Trocken

The component machined by using EMP13 shows better surface quality and verticality than the similar products from company A.

Das Werkstück, das mit EMP13 bearbeitet wurde, weist eine bessere Oberflächengüte und – Vertikalität auf als nach der Bearbeitung mit einem ähnlichen Produkt vom Wettbewerber.

Square Shoulder Milling Tools · Eckfräser

Kr:90°



EMP13 P K

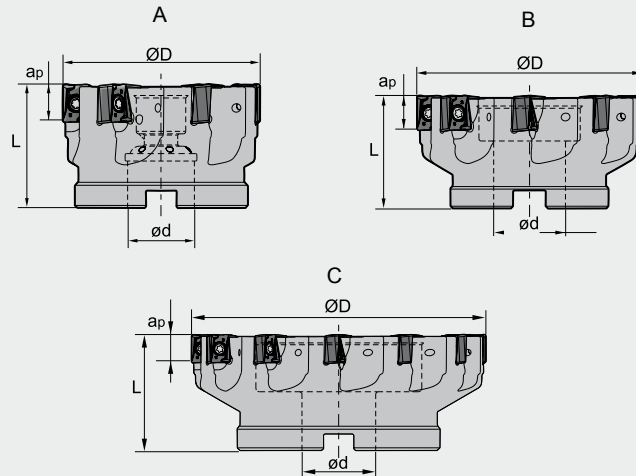

Specification of tools · Werkzeug Beschreibung

Type Typ	*	Stock Lager		Dimension (mm) Abmessung				No. of teeth Zähne	Coupling Aufnahme	Weight Gewicht (kg)	
		R	L	ØD	Ød	L	a _{r,max}				
EMP13	-050-A22-AN11-06	*	●		50	22	40	11.2	6	A	0.30
	-063-A22-AN11-07	*	●		63	22	40	11.2	7	A	0.49
	-080-A27-AN11-09	*	●		80	27	50	11.2	9	A	1.18
	-100-B32-AN11-12	*	●		100	32	50	11.2	12	B	1.46
	-100-B32-AN11-12C	*	○		100	32	50	11.2	12	B	1.46
	-125-B40-AN11-14	*	●		125	40	63	11.2	14	B	2.92
	-125-B40-AN11-14C	*	○		125	40	63	11.2	14	B	2.92
	-160-C40-AN11-16	*	●		160	40	63	11.2	16	C	4.30
EMP13	-050-A22-AN15-04	*	●		50	22	40	14.5	4	A	0.26
	-063-A22-AN15-05	*	●		63	22	40	14.5	5	A	0.53
	-080-A27-AN15-06	*	●		80	27	50	14.5	6	A	1.23
	-100-B32-AN15-08	*	○		100	32	50	14.5	8	B	1.52
	-100-B32-AN15-08C	*	○		100	32	50	14.5	8	B	1.52
	-125-B40-AN15-10	*	●		125	40	63	14.5	10	B	3.05
	-125-B40-AN15-10C	*	○		125	40	63	14.5	10	B	3.05
	-160-C40-AN15-12	*	●		160	40	63	14.5	12	C	4.46

* Internal coolant · Innenkühlung

● Ex stock / ab Lager ○ On demand / auf Anfrage

Spare Parts · Ersatzteile

Diameter Durchmesser Ø D	Insert WSP	Screw Schraube	Torque Drehmoment	Wrench Schlüssel	
Ø50-Ø160	ANGX110504PNR-GM	I60M3X9	2 Nm	WT09IS	
	ANGX110508PNR-GM				
Ø50-Ø160	ANGX150608PNR-GM	I60M4X12	3 Nm	WT15IS	
	ANGX150616PNR-GM				

We recommend to use torque wrenches · Wir empfehlen den Einsatz von Drehmomentschlüsseln

B

Milling Tools
Fräser

Square Shoulder Milling Tools · Eckfräser

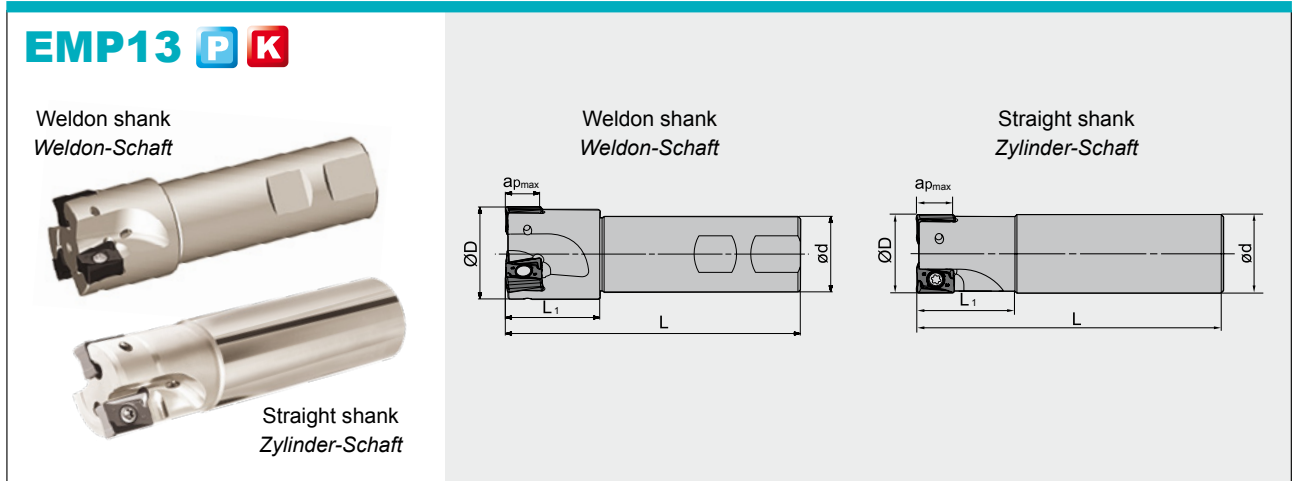

Specification of tools · Werkzeug Beschreibung

Type Typ	*	Stock Lager		Dimension (mm) Abmessung					No. of teeth Zähne	Weight Gewicht (kg)	
		R	L	ØD	Ød	L	L ₁	a _{pmax}			
Weldon shank Weldon-Schaft	EMP13 -025-XP25-AN11-02	*	●		25	25	100	32	11.2	2	0.31
	-032-XP32-AN11-03	*	●		32	32	115	40	11.2	3	0.61
	-040-XP32-AN11-04	*	●		40	32	125	40	11.2	4	0.75
	-032-XP32-AN15-02	*	●		32	32	125	40	11.2	2	0.66
	-040-XP32-AN15-03	*	●		40	32	125	40	11.2	3	0.76
Straight shank Zylinder-Schaft	EMP13 -025-G25-AN11-02	*	●		25	25	100	32	11.2	2	0.31
	-032-G32-AN11-03	*	●		32	32	115	40	11.2	3	0.61
	-040-G32-AN11-04	*	●		40	32	125	40	11.2	4	0.75
	-032-G32-AN15-02	*	●		32	32	125	40	14.5	2	0.66
	-040-G32-AN15-03	*	●		40	32	125	40	14.5	3	0.76

* Internal coolant · Innenkühlung

● Ex stock / ab Lager ○ On demand / auf Anfrage

Spare Parts · Ersatzteile

Diameter Durchmesser Ø D	Insert WSP	Screw Schraube	Torque Drehmoment	Wrench Schlüssel
Ø25-Ø40	ANGX110504PNR-GM	I60M3X9	2 Nm	WT09IS
	ANGX110508PNR-GM			
Ø32-Ø40	ANGX150608PNR-GM	I60M4X12	3 Nm	WT15IS
	ANGX150616PNR-GM			

We recommend to use torque wrenches · Wir empfehlen den Einsatz von Drehmomentschlüsseln

Square Shoulder Milling Tools · Eckfräser

Kr:90°



EMP13 P K

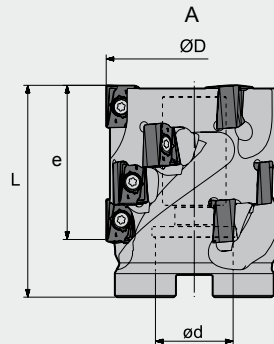



■ Specification of tools · Werkzeug Beschreibung

Type Typ	Stock Lager	Dimension (mm) Abmessung				No. of teeth Zähne	No. of inserts Plattenanzahl	Coupling Aufnahme	Weight Gewicht (kg)		
		R	L	ØD	Ød					L	e
EMP13 -050X43-A22-AN11-03	○			50	22	60	43	3	12	A	0.52
-063X64-A27-AN11-04	○			63	27	80	64	4	24	A	1.15
-063X53-A27-AN15-03	○			63	27	75	53	3	12	A	1.14
-080X53-A32-AN15-04	○			80	32	75	53	4	16	A	1.82

● Ex stock / ab Lager ○ On demand / auf Anfrage

■ Spare Parts · Ersatzteile

Diameter Durchmesser Ø D	Insert WSP	Screw Schraube	Torque Drehmoment	Wrench Schlüssel
Ø50-Ø63	 ANGX110504PNR-GM	 I60M3X9	2 Nm	 WT09IS
Ø63-Ø80	ANGX150608PNR-GM	I60M4X12	3 Nm	WT15IS



We recommend to use torque wrenches · Wir empfehlen den Einsatz von Drehmomentschlüsseln

B

Milling Tools
Fräser

Square Shoulder Milling Tools · Eckfräser

Kr:90°



EMP13 **P** **K**

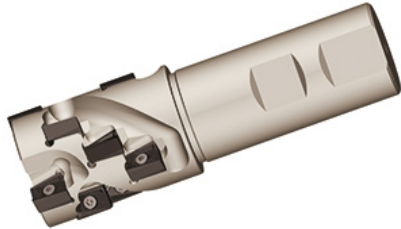

Weldon shank
Weldon-Schaft

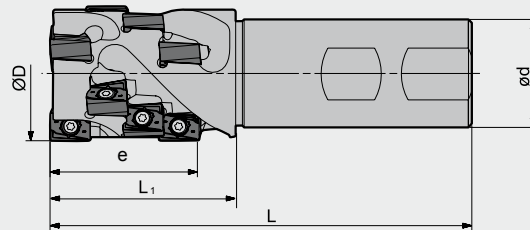

■ Specification of tools · Werkzeug Beschreibung

Type Typ	Stock Lager		Dimension (mm) Abmessung					No. of teeth Zähne	No. of inserts Plattenanzahl	Weight Gewicht (kg)
	R	L	ØD	Ød	L	L ₁	e			
EMP13 -032X43-XP32-AN11-02	○		32	32	115	48	43	2	8	0.61
-040X43-XP32-AN11-03	○		40	32	125	55	43	3	12	0.79
-040X40-XP32-AN15-02	○		40	32	115	55	40	2	6	0.79
-050X53-XP40-AN15-02	○		50	40	145	70	53	2	8	1.53

● Ex stock / ab Lager ○ On demand / auf Anfrage

■ Spare Parts · Ersatzteile

Diameter Durchmesser Ø D	Insert WSP	Screw Schraube	Torque Drehmoment	Wrench Schlüssel
Ø32-Ø40	 ANGX110504PNR-GM	 I60M3X9	2 Nm	 WT09IS
Ø40-Ø50	 ANGX150608PNR-GM	 I60M4X12	3 Nm	 WT15IS

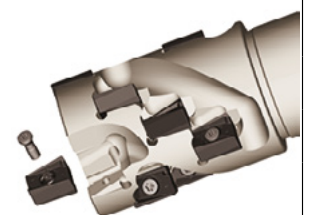

We recommend to use torque wrenches · Wir empfehlen den Einsatz von Drehmomentschlüsseln

Applicable inserts · Wendeschneidplatten

● Ideal Machining Condition / Condiciones de corte estables
● Normal Machining Condition / Condiciones de corte normales
● Unfavorable Machining Condition / Condiciones de corte desfavorables

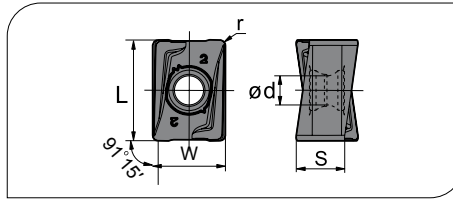

Workpiece Material / Werkstoffe	P	M	K	N	S	Steel / Acero	Stainless Steel / Acero inoxidable	Cast iron / Fundicion	Non-ferrite material / Materiales no ferricos	Heat-resistant steel / Aleaciones termoresistentes
P	●	●	●	●	●	●	●	●	●	●
M	●	●	●	●	●	●	●	●	●	●
K	●	●	●	●	●	●	●	●	●	●
N	●	●	●	●	●	●	●	●	●	●
S	●	●	●	●	●	●	●	●	●	●

Insert shape / Plattenform	Type / Typ	Dimension (mm) / Abmessung					CVD Coating / CVD Beschicht.					PVD Coating / PVD Beschicht.			Cermet / Cermet	Carbide uncoat. / unbe. Hartmetall									
		L	W	S	Ød	r	YBC301	YBC302	YBC401	YBM251	YBM253	YBM351	YBD152	YBD252		YBG102	YBG202	YBG205	YBG302	YBG152	YBG252	YNG151	YNG151C	YC305	YD101
	ANGX110504PNR-GM	11.85	8.4	5.7	3.5	0.4					●	●													
	ANGX110508PNR-GM	11.85	8.4	5.7	3.5	0.8					●	●													
	ANGX150608PNR-GM	15.43	11.0	7.3	4.4	0.8					●	●													
	ANGX150616PNR-GM	15.43	11.0	7.3	4.4	1.6					●	●													

Recommended cutting data · Empfohlene Schnittdaten

Workpiece material / Werkstückstoff	Hardness HB / Härte	Grade / Sorte	Cutting data / Schnittdaten		
			V (m/min)	f (mm/z)	a _p max
P Low-carbon steel / Soft steel / Niedriglegierter Kohlenstoffstahl Alloy tool steel / Leg. Werkzeugstahl	≤180	YBM253	270 (220-350)	0.25 (0.1-0.4)	11.2(AN11) 14.5(AN15)
		YBG205			
	180-350	YBM253	240 (180-320)	0.2 (0.1-0.4)	
		YBG205			
K Cast iron / Gusseisen	180-250	YBD152	270 (150-300)	0.25 (0.1-0.4)	

Mounting double sided inserts:

Montage von doppelseitigen Wendeschneidplatten bei Fräsen:

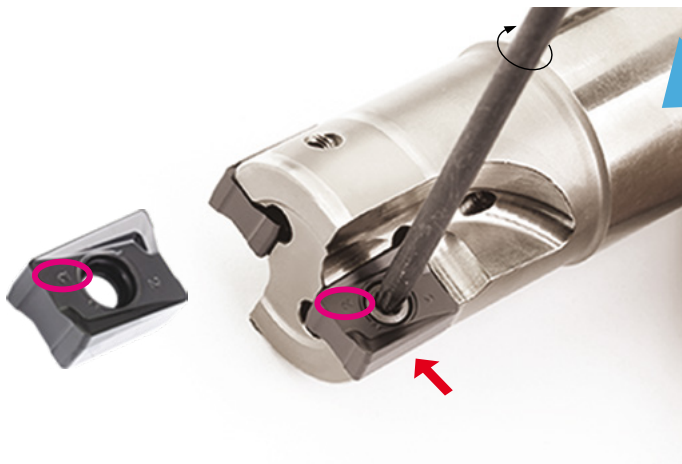

Please make sure that the faces with same marks are in the same direction.

Bitte stellen Sie sicher, dass die Platten mit derselben Markierung in dieselbe Richtung angebracht werden.



Scan for PDF

High performance cutters *Hochleistungsfräser*

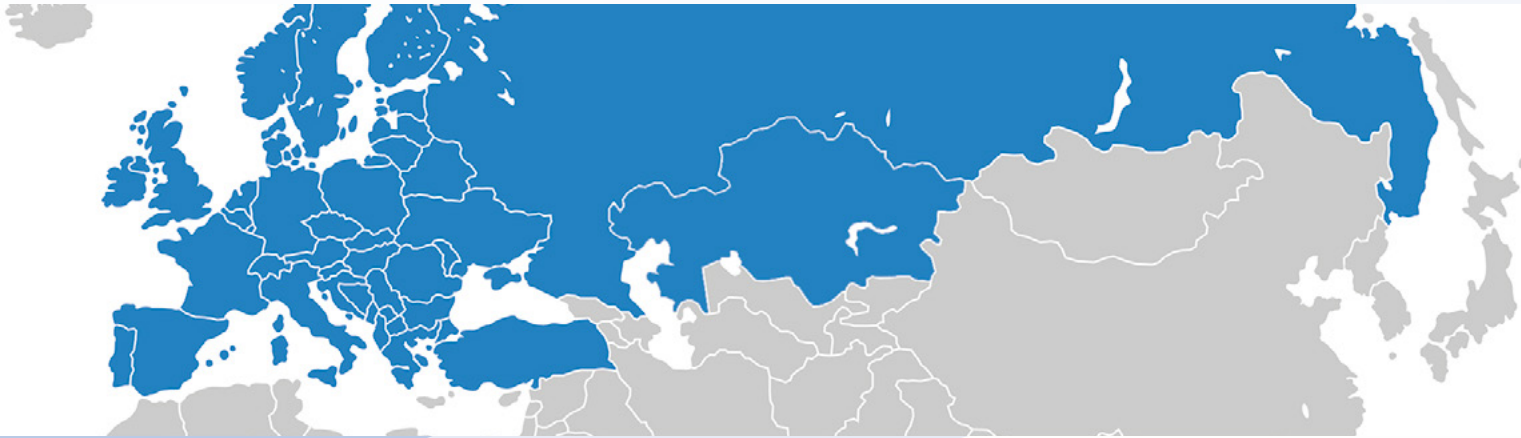

Sales center in Europe
Vertriebszentrale in Europa

ZCC Cutting Tools Europe GmbH

www.zccct-europe.com

Wanheimer Str. 57, 40472 Düsseldorf, Germany

Tel.: +49 (0) 211-989240-0

Fax: +49 (0) 211-989240-111

E-Mail: info@zccct-europe.com

Sales center in France
Vertriebszentrale in Frankreich

ZCC Cutting Tools Europe GmbH Succursale Française

www.zccct-europe.com

14, Allée Charles Pathé, 18000 Bourges, France

Tel.: +33 (0)2-454101-40

Fax: +33 (0)2-486619-46

E-Mail: ventes@zccct-europe.com

© Copyright by ZCC Cutting Tools Europe GmbH
All rights reserved. / *Alle Rechte vorbehalten.*

All rights reserved. All descriptions and pictures are protected by copyright. Usage, modification and reproduction, completely or partially, without written permission are prohibited. Subject to technical changes and changes of the delivery program. Mistakes and printing errors are reserved.

Alle Rechte vorbehalten. Alle Beschreibungen und Abbildungen sind urheberrechtlich geschützt. Die Verwendung, Modifikation und Vervielfältigung, ganz oder teilweise, ohne schriftliche Genehmigung sind untersagt. Technische Änderungen und Änderungen des Lieferprogramms vorbehalten. Für Druckfehler und Irrtümer keine Gewähr.